

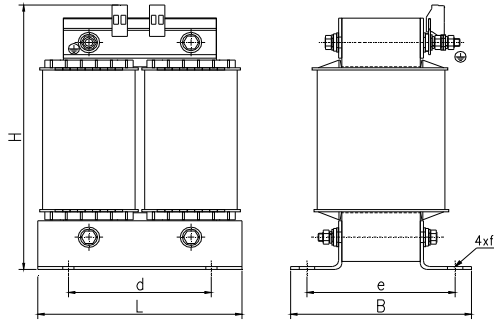

**Single-phase power transformers
with the power range between 2 kVA and 100 kVA**

ET1S



Design A for the power up to 6,3 kVA

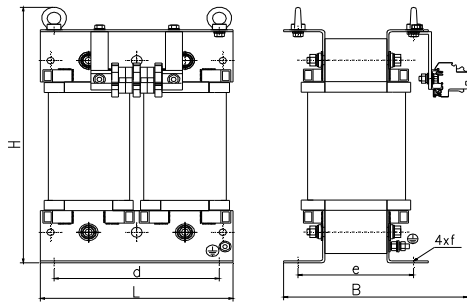

Design B for the power above 6,3 kVA

Technical data:

Design	Power transformers are produced in accordance with requirements of: EN/IEC 61558-2-1; EN/IEC 60726
Insulation class	B(130°C) - standard up to 5 kVA, F(155°C) - standard above 5 kVA
Climatic class /environmental class	C1/E0 - land design C2/E1 - maritime and mining design
Ambient temperature	40°C - land design 45°C - maritime and mining design
Protection degree	IP 00
Protection class	I
Frequency	50/60 Hz
Primary voltage	up to 1000 V
Secondary voltage	up to 1000 V
Terminals	screw terminal blocks or cable lugs or copper bus bars
Fastening	by means of angles

Power transformers are assigned for supplying electric devices, and for application in various industrial branches. In standard design, the transformers are adjusted to fastening by means of a base welded into core or screwed angles.

If agreed, the transformers may have more tapings. The windings terminals may be placed on one side only, or on both sides of a transformer.

Upon request, the transformers may be assembled in enclosures with the protection degree of IP 23, IP 44 and IP 54 with the possibility to insert supply cables through glands.

Technical data of single-phase power transformers ET1S **

Type	Power [kVA]	L [mm]	B [mm]	H [mm]	d [mm]	e [mm]	f [mm]	Weight [kg]	Design
ET1S_* - 2,0	2,0	178	140	240	128	114	11 x 15	17	A
ET1S_* - 2,5	2,5	178	152	240	128	126	11 x 15	21	A
ET1S_* - 3,0	3,0	200	165	271	140	133	11 x 15	23	A
ET1S_* - 3,5	3,5	200	177	271	140	145	11 x 15	27	A
ET1S_* - 4,0	4,0	200	192	271	140	160	11 x 15	30	A
ET1S_* - 5,0	5,0	240	165	323	200	127	11 x 15	35	A
ET1S_* - 6,3	6,3	240	180	323	200	142	11 x 15	40	A
ET1S_* - 7,5	7,5	280	260	425	240	151	11 x 15	46	B
ET1S_* - 8,0	8,0	280	260	425	240	151	11 x 15	48	B
ET1S_* - 10,0	10	280	275	425	240	168	11 x 15	56	B
ET1S_* - 12,0	12	280	290	425	240	178	11 x 15	63	B
ET1S_* - 15,0	15	320	300	485	270	190	13 x 18	74	B
ET1S_* - 16,0	16	320	300	485	270	190	13 x 18	76	B
ET1S_* - 20,0	20	360	330	545	310	220	13 x 18	98	B
ET1S_* - 25,0	25	360	350	545	310	240	13 x 18	120	B
ET1S_* - 30,0	30	360	370	545	310	240	13 x 18	130	B
ET1S_* - 40,0	40	360	420	545	310	270	13 x 18	160	B
ET1S_* - 50,0	50	460	420	615	360	220	13 x 18	190	B
ET1S_* - 63,0	63	460	450	615	360	240	13 x 18	218	B
ET1S_* - 75,0	75	460	480	615	360	270	13 x 18	254	B
ET1S_* - 80,0	80	480	480	715	380	260	17 x 25	268	B
ET1S_* - 100	100	480	410	715	380	290	17 x 25	334	B

*) - for transformer design with climatic/environmental class C2/E2 (maritime design W/3 or tropical design T/3) the letter "M" or "G" ought to be added depending on final application

**) - this table was prepared basing on the technical specification for transformer with voltage ratio 400//400 operating under normal conditions. For other conditions and data the values may change

Note:

Manufacturer reserves the right to make changes resulting from the continuous development of products offered. If requested in advance, it is possible to manufacture transformer in other version.



ET/2014/X/14

Manufacturer: **ELHAND TRANSFORMATORY Sp. z o.o.**
 PL 42-700 Lubliniec, ul. Klonowa 60
 tel.: (34) 34 73 100, fax: (34) 34 70 207
<http://www.elhand.pl> e-mail: info@elhand.pl